

KEY PLAN

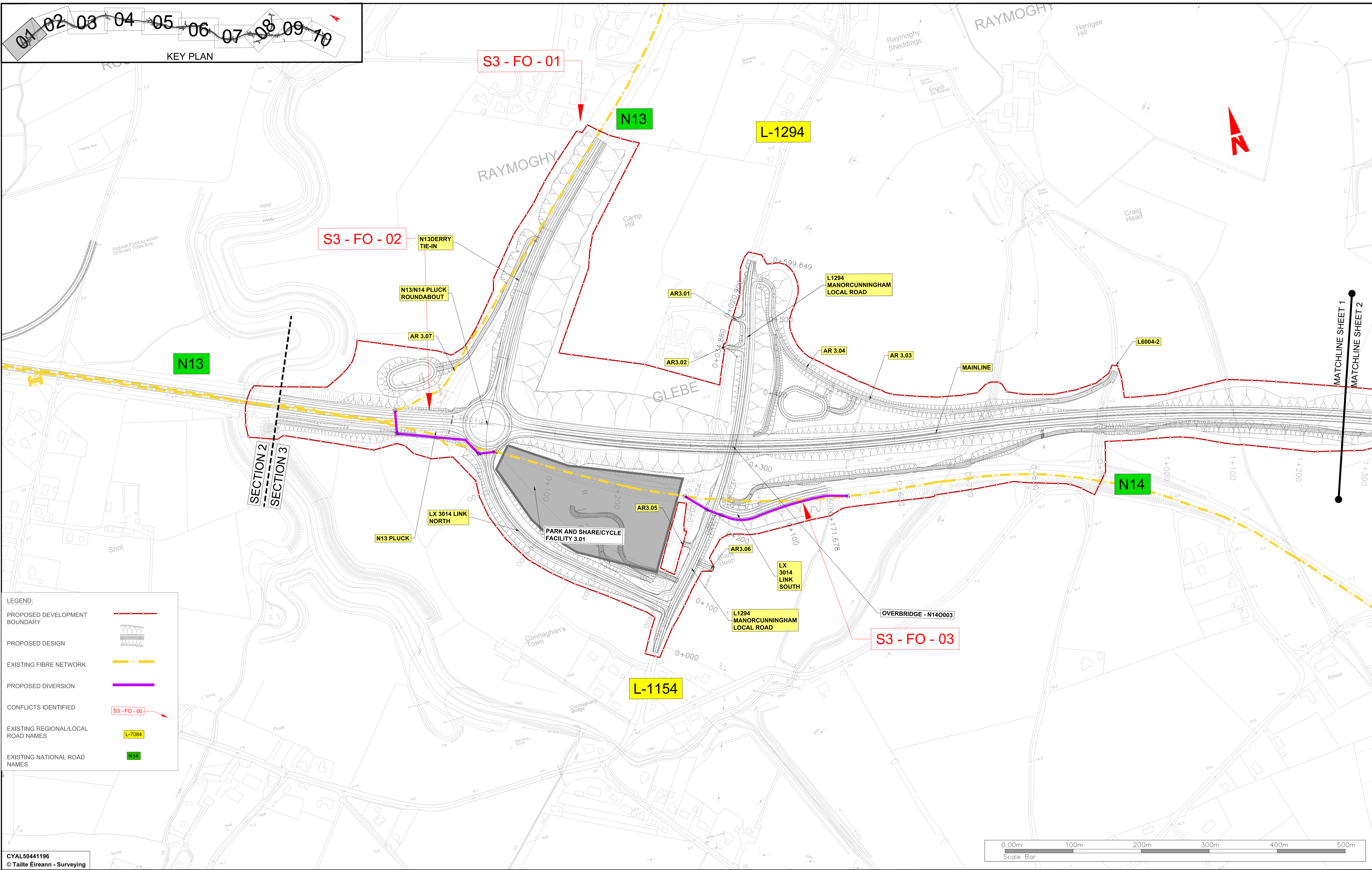

LEGEND:

- PROPOSED DEVELOPMENT BOUNDARY —
- PROPOSED DESIGN
- EXISTING FIBRE NETWORK —
- PROPOSED DIVERSION —
- CONFLICTS IDENTIFIED S3-FO-00
- EXISTING REGIONAL/LOCAL ROAD NAMES L-7084
- EXISTING NATIONAL ROAD NAMES N14

CYAL50441196
© Talte Éireann - Surveying

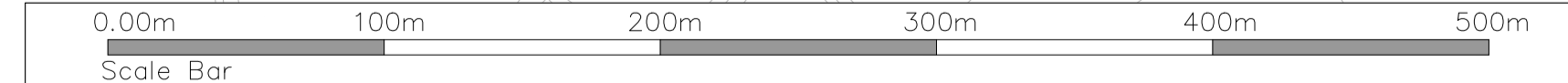

Notes
DO NOT SCALE. Use figured dimensions only. All levels are referred to Ordnance Survey Datum, Main Head.
This drawing is the property of Donegal County Council. It is a confidential document and must not be copied, used, or its contents divulged without prior written consent. This document should not be relied on or used in circumstances other than those for which it was originally prepared. Barry Transportation accepts no responsibility for this document to any other party other than the party by whom it was commissioned.

Rev.	Date	Drawn	Description	Chk'd	Appr.
P01	12.11.25	MG	ISSUE FOR PLANNING	JMM	ED

Project Title: TEN-T PRIORITY ROUTE IMPROVEMENT PROJECT DONEGAL
Section 3 - N14 Manorcunningham to Lifford/Strabane/A5 Link

Drawing Title: Proposed Diversions Fibre Project Kelvin

Status: A3

Designed: JMM **Date:** NOV 2025 **EIAR Drawing Identifier:**

Drawn: MG **Scale @ A1:** 1:2500 **EIAR Drawing 16.19**

Approved: ED **@ A3:** 1:5000 **File Identifier:** TT_Y16112-BT-1A-HUT-S3-DR-CU-27042

Checked: JMM **Sheet:** Sheet 1 of 10

\\legis.racine.local\bu_mens\BIB\0_P\Projects\Dublin\Projects\Halcrow\Barry\16 Projects\Y16112-BT-1A-HUT-S3-DR-CU-27042_Proposed Diversions Fibre Project_Kelvin.dwg

\egis\racine\localbu\mens\UBB\0 - Projects\Dublin\Projects\Halcrow\Barry\16 Projects\Y16112-BT-1A-HUT-S3-DR-CU-27042_Proposed_Diversions_Fibre_Project_Kelvin.dwg

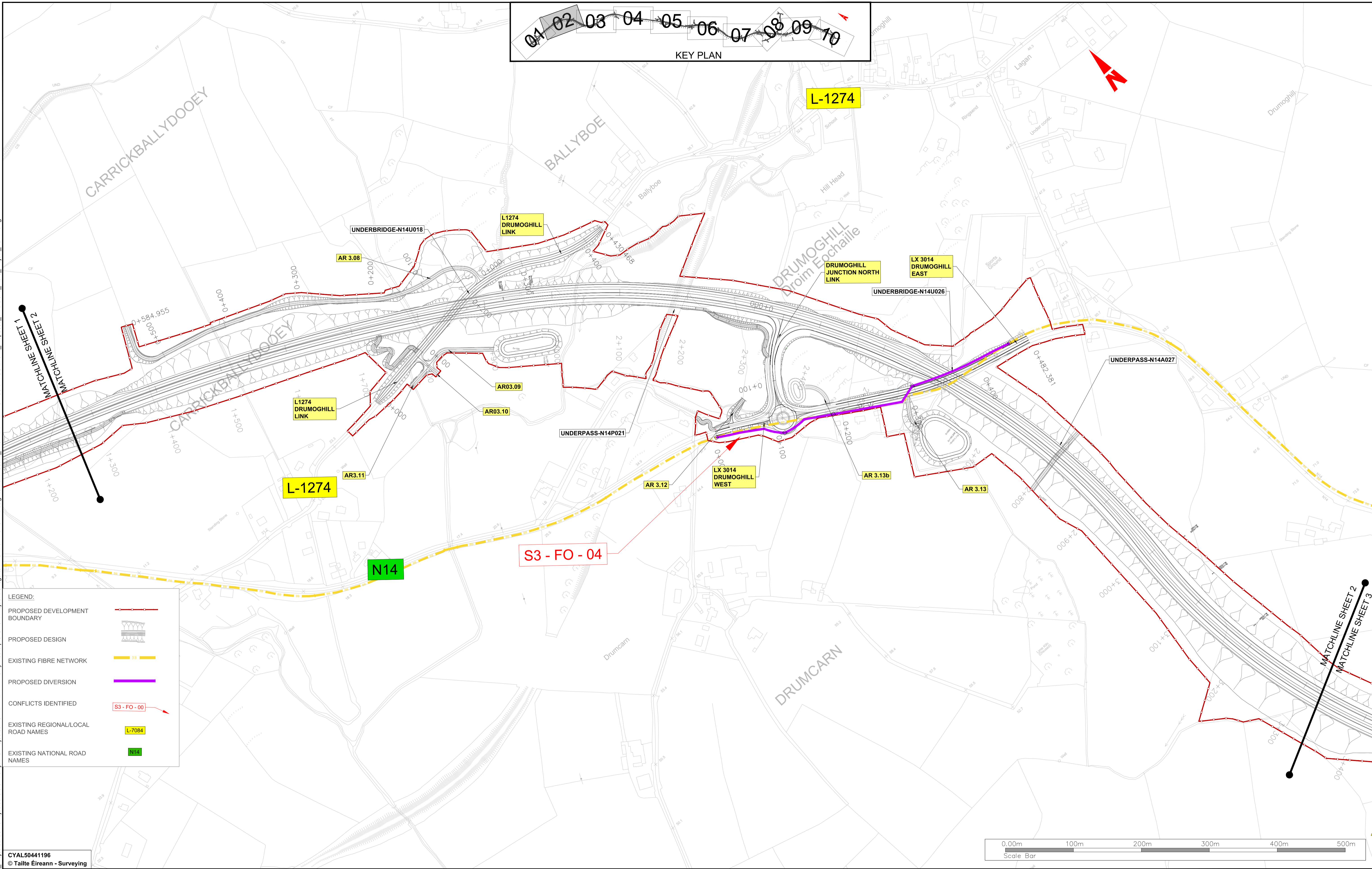
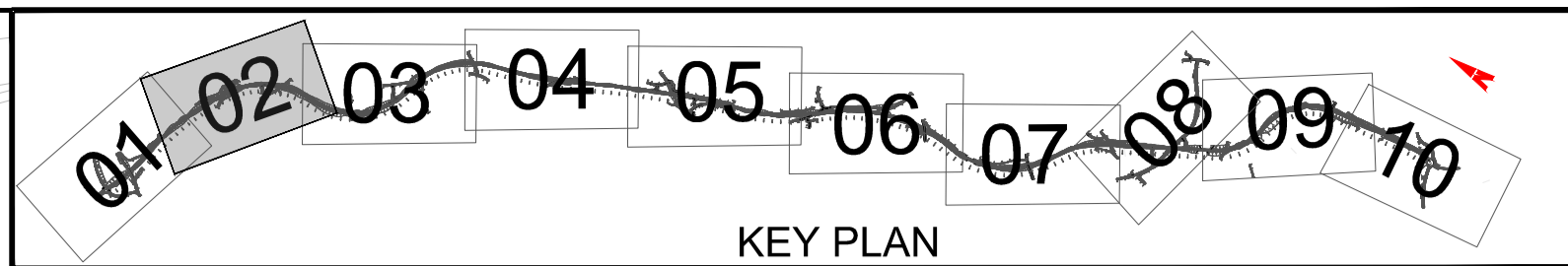

LEGEND:

PROPOSED DEVELOPMENT BOUNDARY	
PROPOSED DESIGN	
EXISTING FIBRE NETWORK	
PROPOSED DIVERSION	
CONFLICTS IDENTIFIED	
EXISTING REGIONAL/LOCAL ROAD NAMES	
EXISTING NATIONAL ROAD NAMES	

CYAL50441196
© Taitte Éireann - Surveying

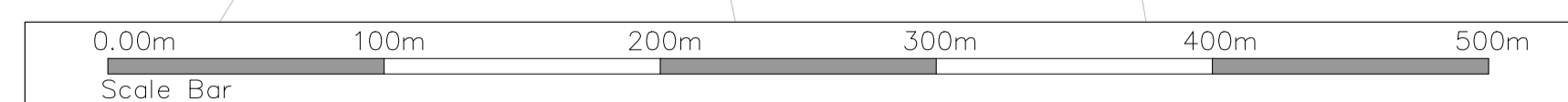

Notes
 DO NOT SCALE. Use figured dimensions only. All levels are referred to Ordnance Survey Datum, Mean Head.
 This drawing is the property of Donegal County Council. It is a confidential document and must not be copied, used, or its contents divulged without prior written consent. This document should not be relied on or used in circumstances other than those for which it was originally prepared. Barry Transportation accepts no responsibility for this document to any other party other than the party by whom it was commissioned.

Rev.	Date	Drawn	Description	Chk'd	Appr.
P01	12.11.25	MG	ISSUE FOR PLANNING	JMM	ED

Project Title: TEN-T PRIORITY ROUTE IMPROVEMENT PROJECT DONEGAL Section 3 - N14 Manorcunningham to Lifford/Strabane/A5 Link		Status: A3
Drawing Title: Proposed Diversions Fibre Project Kelvin		Rev: P01
Designed: JMM	Date: NOV 2025	EIAR Drawing Identifier:
Drawn: MG	Scale @ A1: 1:2500	EIAR Drawing 16.19
Approved: ED	@ A3: 1:5000	File Identifier:
Checked: JMM	Sheet: 2 OF 10	TT_Y16112-BT-1A-HUT-S3-DR-CU-27042

LEGEND:

- PROPOSED DEVELOPMENT BOUNDARY
- PROPOSED DESIGN
- EXISTING FIBRE NETWORK
- PROPOSED DIVERSION
- CONFLICTS IDENTIFIED
- EXISTING REGIONAL/LOCAL ROAD NAMES
- EXISTING NATIONAL ROAD NAMES

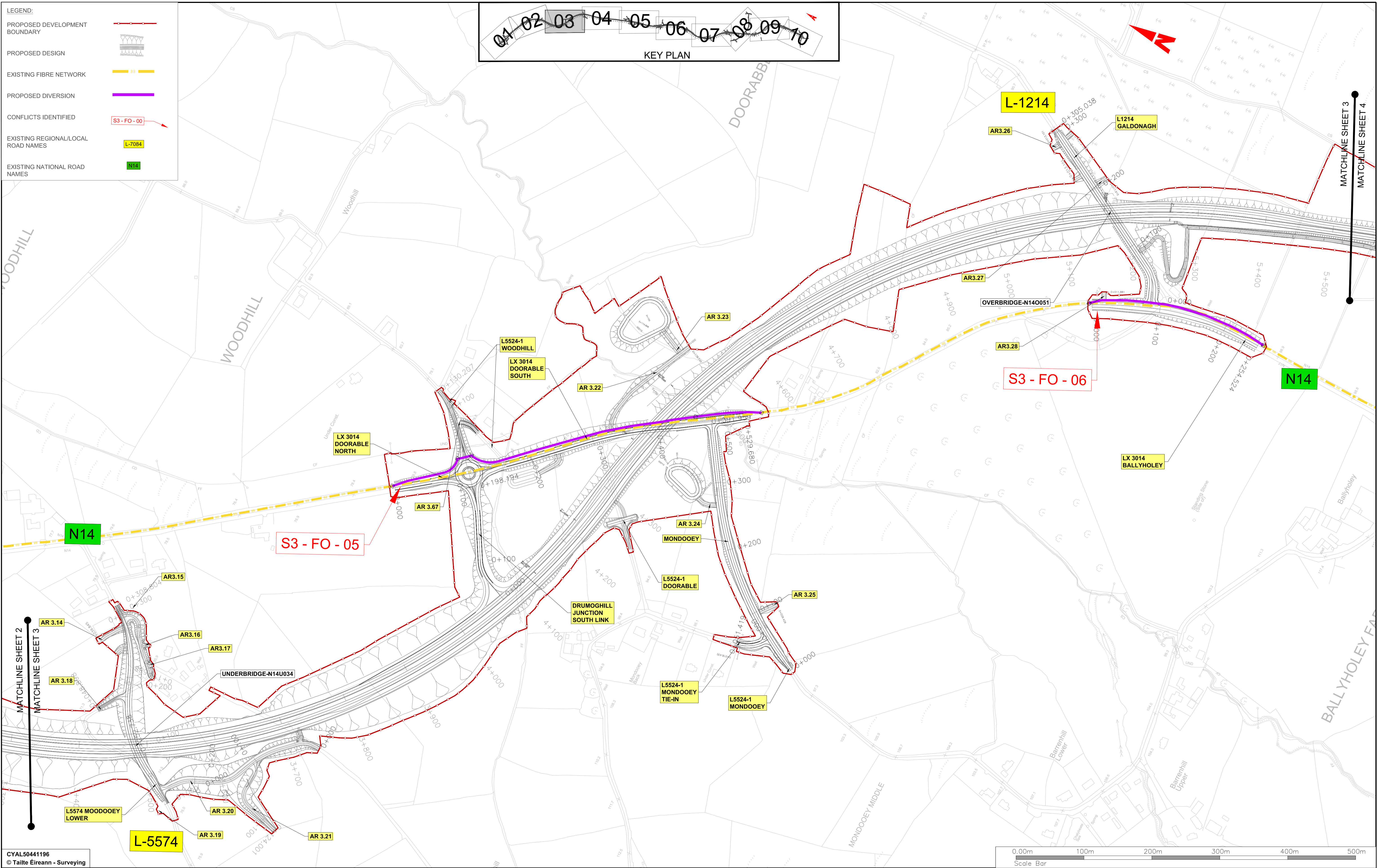
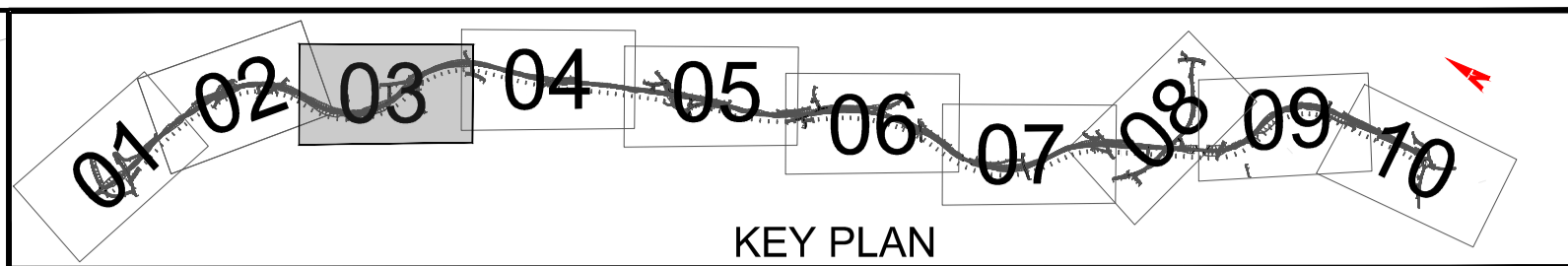

CYAL50441196
© Taitte Éireann - Surveying

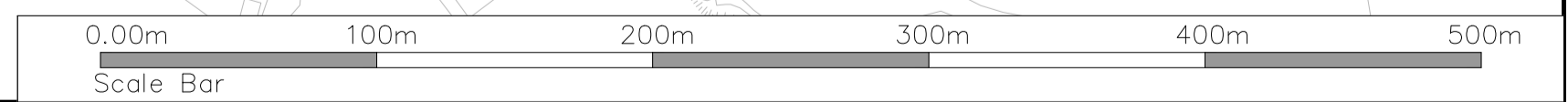

Notes
DO NOT SCALE. Use figured dimensions only. All levels are referred to Ordnance Survey Datum, Mean Head.
This drawing is the property of Donegal County Council. It is a confidential document and must not be copied, used, or its contents divulged without prior written consent. This document should not be relied on or used in circumstances other than those for which it was originally prepared. Barry Transportation accepts no responsibility for this document to any other party other than the party by whom it was commissioned.

Rev.	Date	Drawn	Description	Chk'd	Appr.
P01	12.11.25	MG	ISSUE FOR PLANNING	JMM	ED

Project Title: TEN-T PRIORITY ROUTE IMPROVEMENT PROJECT DONEGAL Section 3 - N14 Manorcunningham to Lifford/Strabane/A5 Link		Status: A3	
Drawing Title: Proposed Diversions Fibre Project Kelvin		Rev: P01	
Designed: JMM	Date: NOV 2025	EIA Drawing Identifier: EIA Drawing 16.19	
Drawn: MG	Scale @ A1: 1:2500	File Identifier: TT_Y16112-BT-1A-HUT-S3-DR-CU-27042	
Approved: ED	@ A3: 1:5000		
Checked: JMM	Sheet: 3 OF 10		

V:\gis\racine\local\bu_mens\UBS\0 - Projects\Dublin\Projects\Halcrow\Barry\16 - TEN-T Priority Route Improvement Project Donegal\Civil\CAD\WIP\Prelim Design\CIV\DWG\GtTT_Y16112-BT-1A-HUT-S3-DR-CU-27042_Proposed_Diversions_Fibre_Project_Kelvin.dwg

LEGEND:

- PROPOSED DEVELOPMENT BOUNDARY
- PROPOSED DESIGN
- EXISTING FIBRE NETWORK
- PROPOSED DIVERSION
- CONFLICTS IDENTIFIED
- EXISTING REGIONAL/LOCAL ROAD NAMES
- EXISTING NATIONAL ROAD NAMES

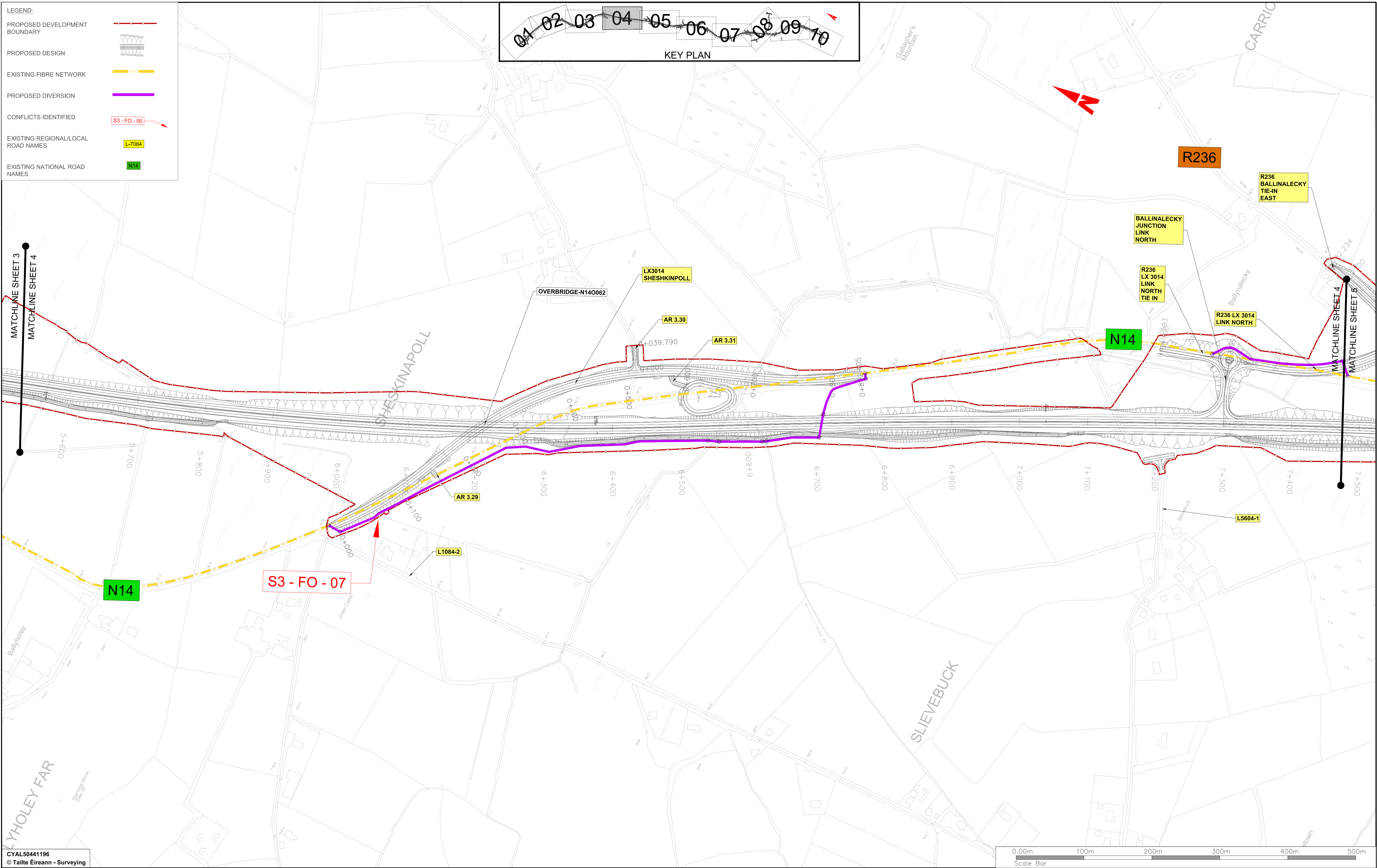
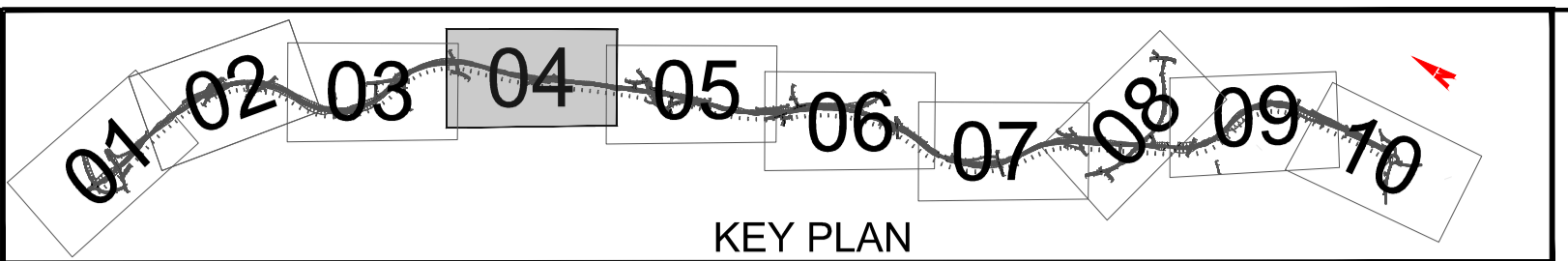

MATCHLINE SHEET 3
MATCHLINE SHEET 4

MATCHLINE SHEET 4
MATCHLINE SHEET 5

CYAL50441196
© Taite Éireann - Surveying

Notes
DO NOT SCALE. Use figured dimensions only. All levels are referred to Ordnance Survey Datum, Mean Head.
This drawing is the property of Donegal County Council. It is a confidential document and must not be copied, used, or its contents divulged without prior written consent. This document should not be relied on or used in circumstances other than those for which it was originally prepared. Barry Transportation accepts no responsibility for this document to any other party other than the party by whom it was commissioned.

Rev.	Date	Drawn	Description	Chk'd	Appr.
P01	12.11.25	MG	ISSUE FOR PLANNING	JMM	ED

Project Title: TEN-T PRIORITY ROUTE IMPROVEMENT PROJECT DONEGAL Section 3 - N14 Manor Cunninghamham to Lifford/Strabane/A5 Link

Drawing Title: Proposed Diversions Fibre Project Kelvin

Status: A3

Revised: P01

Designed: JMM **Date:** NOV 2025 **EIAR Drawing Identifier:**

Drawn: MG **Scale @ A1:** 1:2500 **EIAR Drawing 16.19**

Approved: ED **@ A3:** 1:5000 **File Identifier:**

Checked: JMM **Sheet:** 4 OF 10 **TT_Y16112-BT-1A-HUT-S3-DR-CU-27042**

V:\gis\racine\local\bu_mens\UBB\0 - Projects\Dublin\Projects\Halcrow\Barry\16 Projects\Y16112 - TEN-T Priority Route Improvement Project Donegal\Civil\CAD\WIP\Prelim Design\CIV\DWG\Sheet_Y16112-BT-1A-HUT-S3-DR-CU-27042_Proposed_Diversions_Fibre_Project_Kelvin.dwg

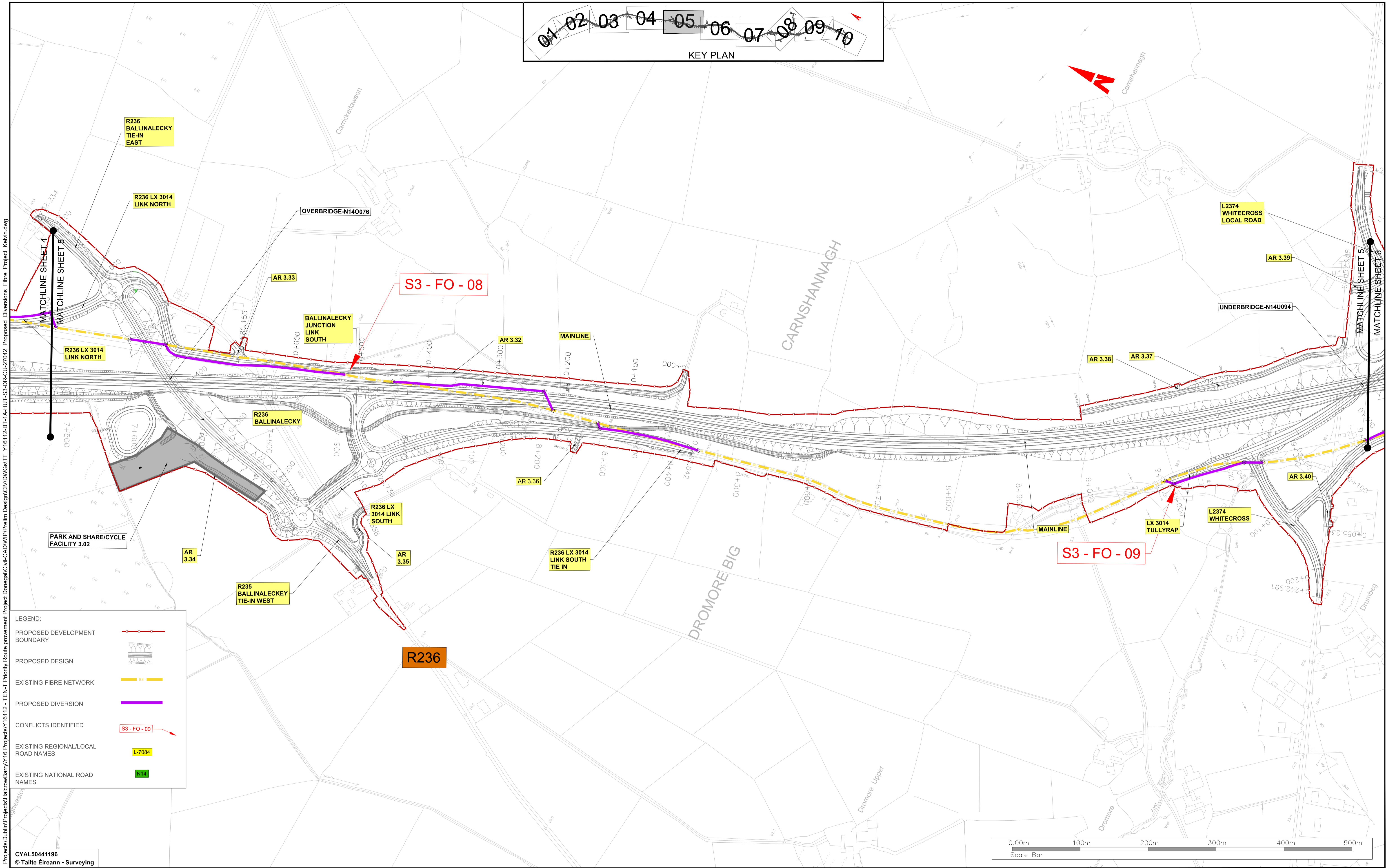
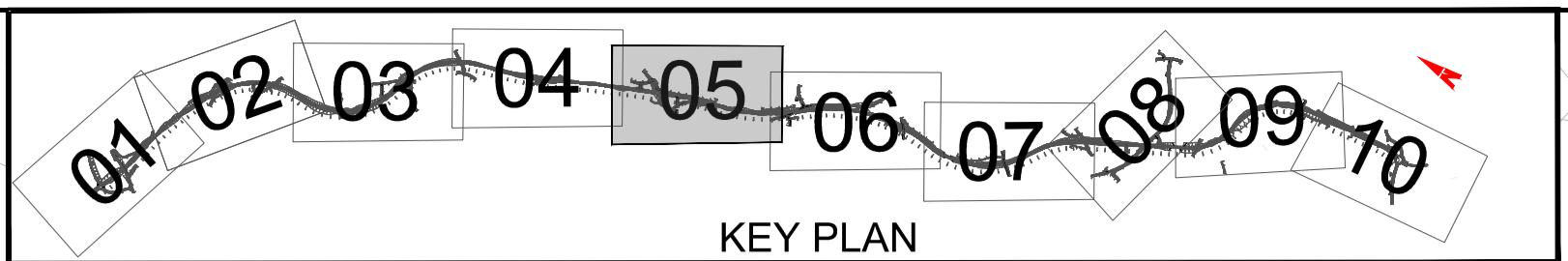

LEGEND:

PROPOSED DEVELOPMENT BOUNDARY	
PROPOSED DESIGN	
EXISTING FIBRE NETWORK	
PROPOSED DIVERSION	
CONFLICTS IDENTIFIED	
EXISTING REGIONAL/LOCAL ROAD NAMES	
EXISTING NATIONAL ROAD NAMES	

CYAL50441196
© Talte Éireann - Surveying

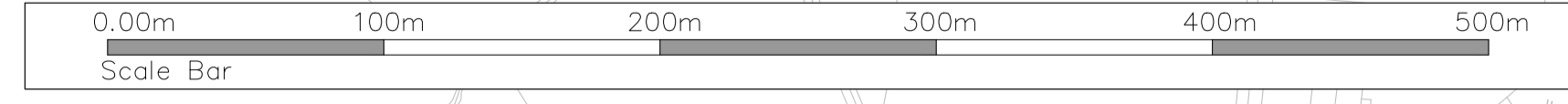

Notes
DO NOT SCALE, use figured dimensions only. All levels are referred to Ordnance Survey Datum, Mean Head.
This drawing is the property of Donegal County Council. It is a confidential document and must not be copied, used, or its contents divulged without prior written consent. This document should not be relied on or used in circumstances other than those for which it was originally prepared. Barry Transportation accepts no responsibility for this document to any other party other than the party by whom it was commissioned.

Rev.	Date	Drawn	Description	Chk'd	Appr.
P01	12.11.25	MG	ISSUE FOR PLANNING	JMM	ED

Project Title: TEN-T PRIORITY ROUTE IMPROVEMENT PROJECT DONEGAL		Section 3 - N14 Manorunningham to Lifford/Strabane/A5 Link	
Drawing Title: Proposed Diversions Fibre Project Kelvin		Status: A3	
Designed: JMM	Date: NOV 2025	EIAR Drawing Identifier:	Rev: P01
Drawn: MG	Scale @ A1: 1:2500	EIAR Drawing 16.19	
Approved: ED	@ A3: 1:5000	File Identifier:	
Checked: JMM	Sheet: 5 OF 10	TT_Y16112-BT-1A-HUT-S3-DR-CU-27042	

Vegis.racine.local\bu_mens\BIB\0_P\Projects\Donegal\Projects\Halcrow\Barry\16 Projects\Y16112 - TEN-T Priority Route Improvement Project Donegal\Civil\CAD\WIP\Prelim Design\CIV\DWG\ITT_Y16112-BT-1A-HUT-S3-DR-CU-27042_Proposed Diversions Fibre Project_Kelvin.dwg

\egis\racine\local\bu_mens\UBB\0 - Projects\Dublin\Projects\Halcrow\Barry\16 Projects\Y16112 - TEN-T Priority Route Improvement Project Donegal\Civil\DWG\ITTT_Y16112-BT-1A-HUT-S3-DR-CU-27042_Proposed_Diversions_Fibre_Project_Kelvin.dwg

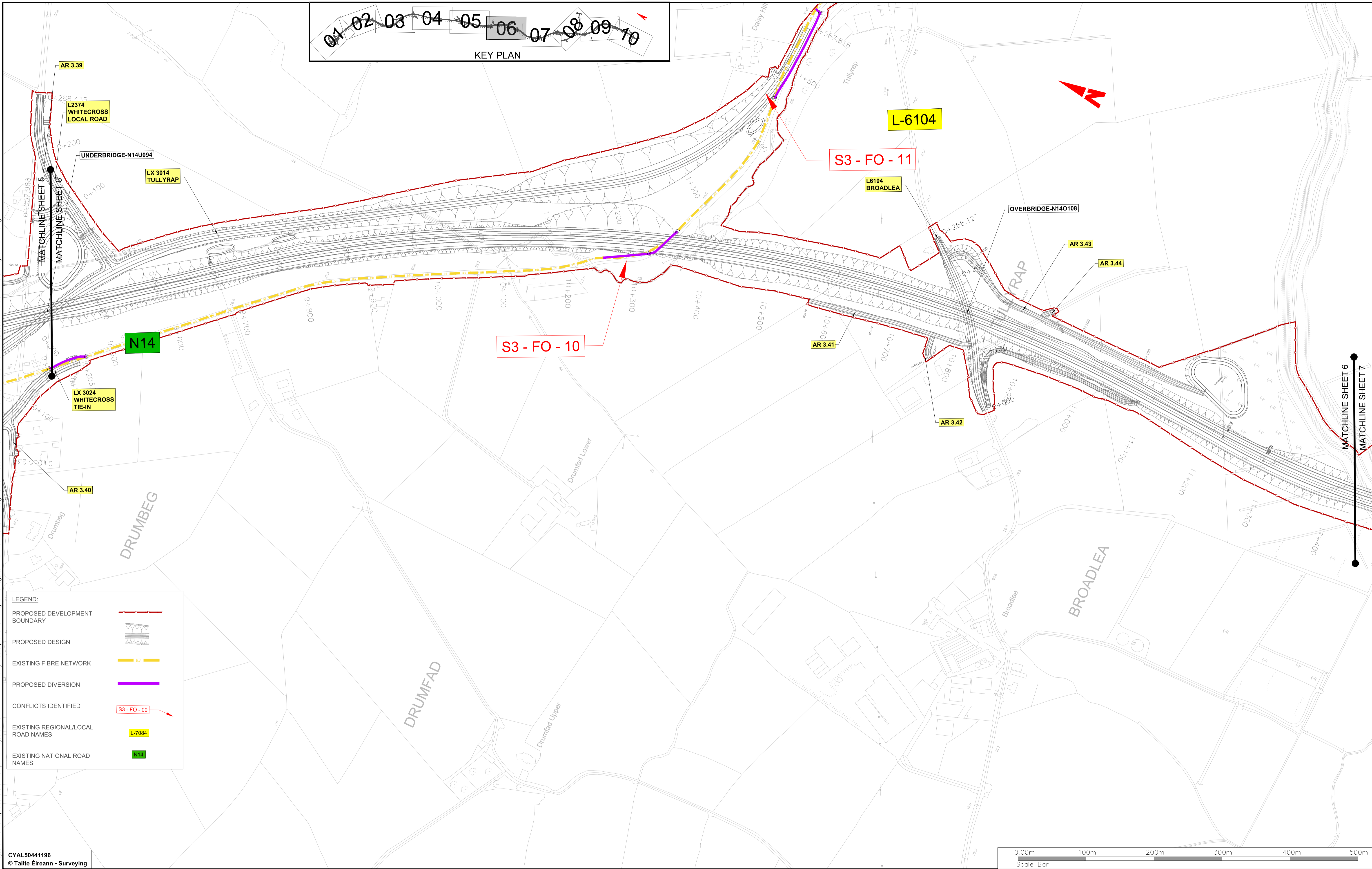
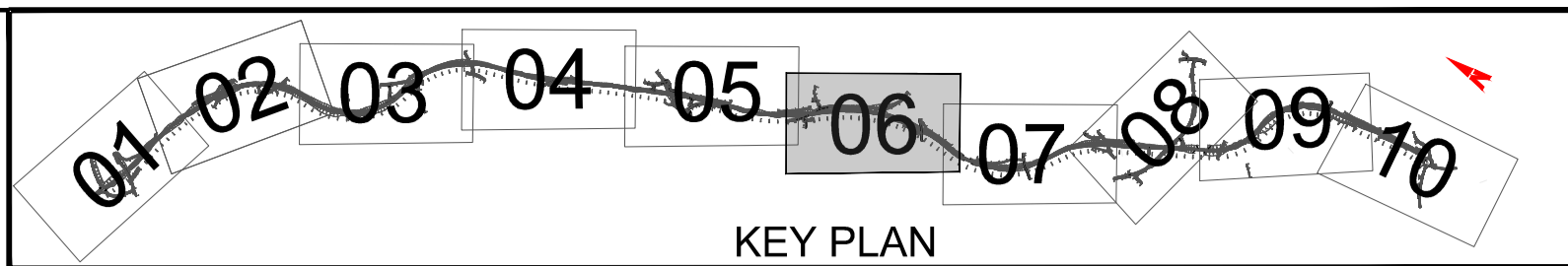

LEGEND:

PROPOSED DEVELOPMENT BOUNDARY	
PROPOSED DESIGN	
EXISTING FIBRE NETWORK	
PROPOSED DIVERSION	
CONFLICTS IDENTIFIED	
EXISTING REGIONAL/LOCAL ROAD NAMES	
EXISTING NATIONAL ROAD NAMES	

CYAL50441196
© Taitte Éireann - Surveying

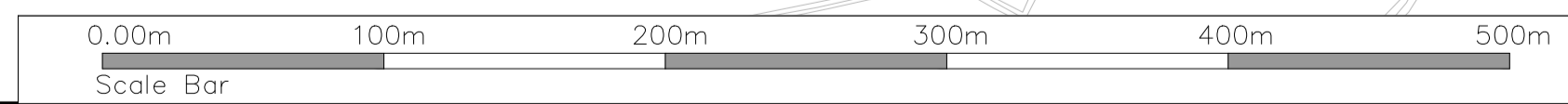

Notes
 DO NOT SCALE. Use figured dimensions only. All levels are referred to Ordnance Survey Datum, Mean Head.
 This drawing is the property of Donegal County Council. It is a confidential document and must not be copied, used, or its contents divulged without prior written consent. This document should not be relied on or used in circumstances other than those for which it was originally prepared. Barry Transportation accepts no responsibility for this document to any other party other than the party by whom it was commissioned.

Rev.	Date	Drawn	Description	Chk'd	Appr.
P01	12.11.25	MG	ISSUE FOR PLANNING	JMM	ED

Project Title: TEN-T PRIORITY ROUTE IMPROVEMENT PROJECT DONEGAL		Section 3 - N14 Manorunningham to Lifford/Strabane/A5 Link	
Drawing Title: Proposed Diversions Fibre Project Kelvin		Status: A3	
Designed: JMM	Date: NOV 2025	EIA Drawing Identifier: EIA Drawing 16.19	
Drawn: MG	Scale @ A1: 1:2500	Rev: P01	
Approved: ED	@ A3: 1:5000	File Identifier: TT_Y16112-BT-1A-HUT-S3-DR-CU-27042	
Checked: JMM	Sheet: 6 OF 10		

LEGEND:

- PROPOSED DEVELOPMENT BOUNDARY
- PROPOSED DESIGN
- EXISTING FIBRE NETWORK
- PROPOSED DIVERSION
- CONFLICTS IDENTIFIED
- EXISTING REGIONAL/LOCAL ROAD NAMES
- EXISTING NATIONAL ROAD NAMES

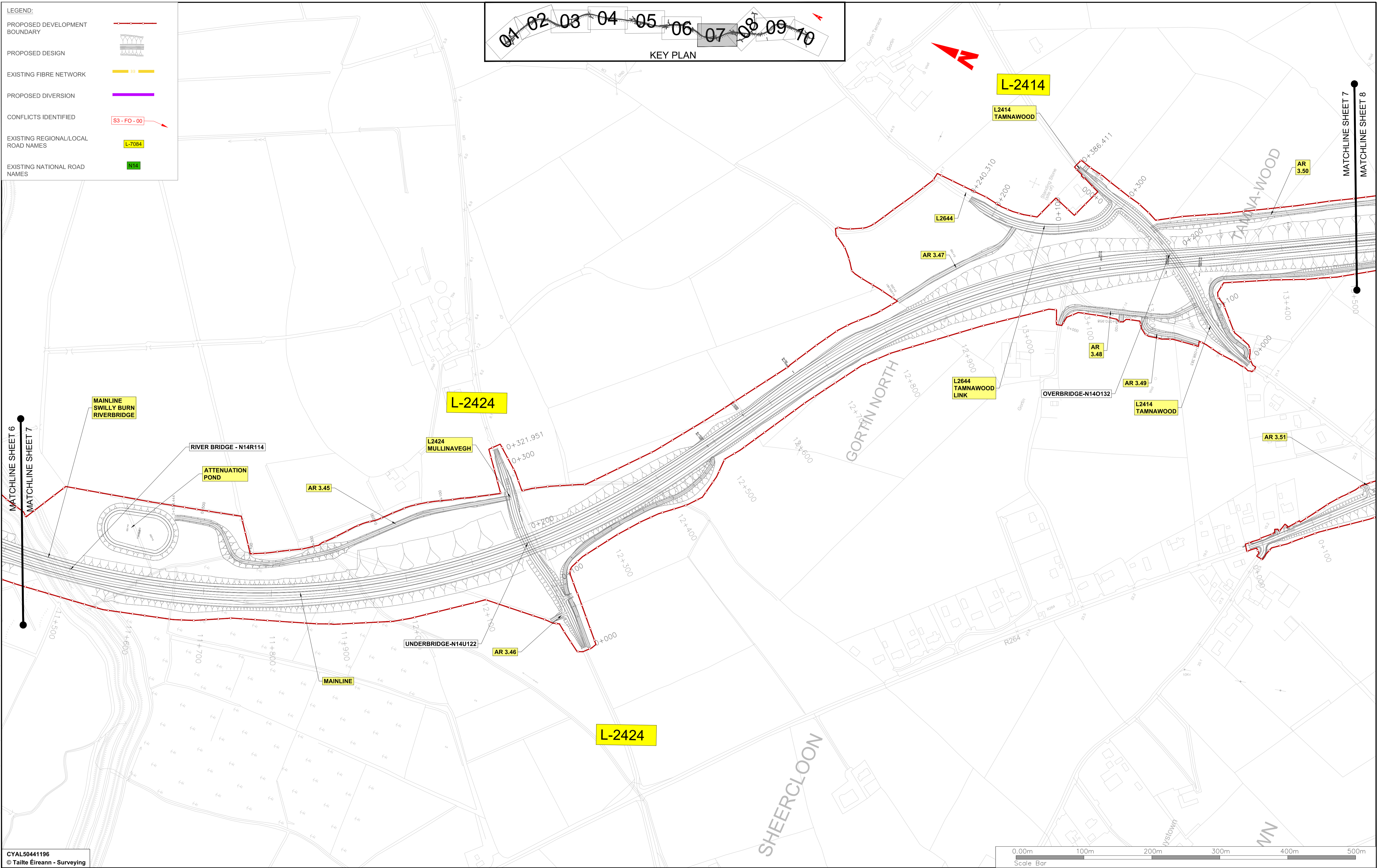
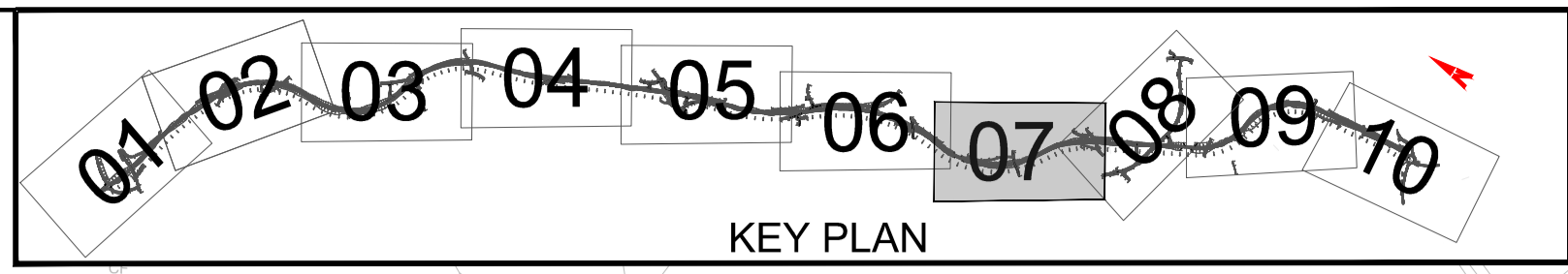

CYAL50441196
© Taitte Éireann - Surveying

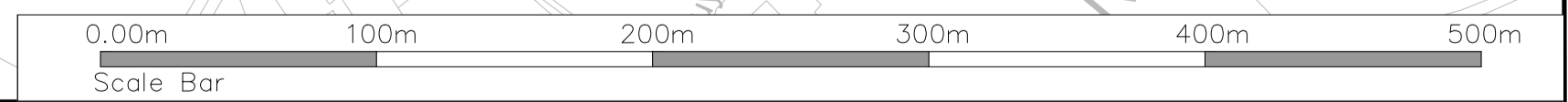

Notes
DO NOT SCALE. Use figured dimensions only. All levels are referred to Ordnance Survey Datum, Mean Head.
This drawing is the property of Donegal County Council. It is a confidential document and must not be copied, used, or its contents divulged without prior written consent. This document should not be relied on or used in circumstances other than those for which it was originally prepared. Barry Transportation accepts no responsibility for this document to any other party other than the party by whom it was commissioned.

Rev.	Date	Drawn	Description	Chk'd	Appr.
P01	12.11.25	MG	ISSUE FOR PLANNING	JMM	ED

Project Title: TEN-T PRIORITY ROUTE IMPROVEMENT PROJECT DONEGAL
Section 3 - N14 Manorcunningham to Lifford/Strabane/A5 Link

Drawing Title: Proposed Diversions Fibre Project Kelvin

Status: A3

Designed: JMM **Date:** NOV 2025 **EIAR Drawing Identifier:**

Drawn: MG **Scale @ A1:** 2500 **EIAR Drawing 16.19**

Approved: ED **@ A3:** 1:5000 **File Identifier:**

Checked: JMM **Sheet:** 7 OF 10 **TT_Y16112-BT-1A-HUT-S3-DR-CU-27042**

Rev: P01

V:\gis\racine\local\bu_mens\UBS\0 - Projects\Dublin\Projects\Halcrow\Barry\16 Projects\Y16112-BT-1A-HUT-S3-DR-CU-27042_Proposed_Diversions_Fibre_Project_Kelvin.dwg

LEGEND:

- PROPOSED DEVELOPMENT BOUNDARY
- PROPOSED DESIGN
- EXISTING FIBRE NETWORK
- PROPOSED DIVERSION
- CONFLICTS IDENTIFIED
- EXISTING REGIONAL/LOCAL ROAD NAMES
- EXISTING NATIONAL ROAD NAMES

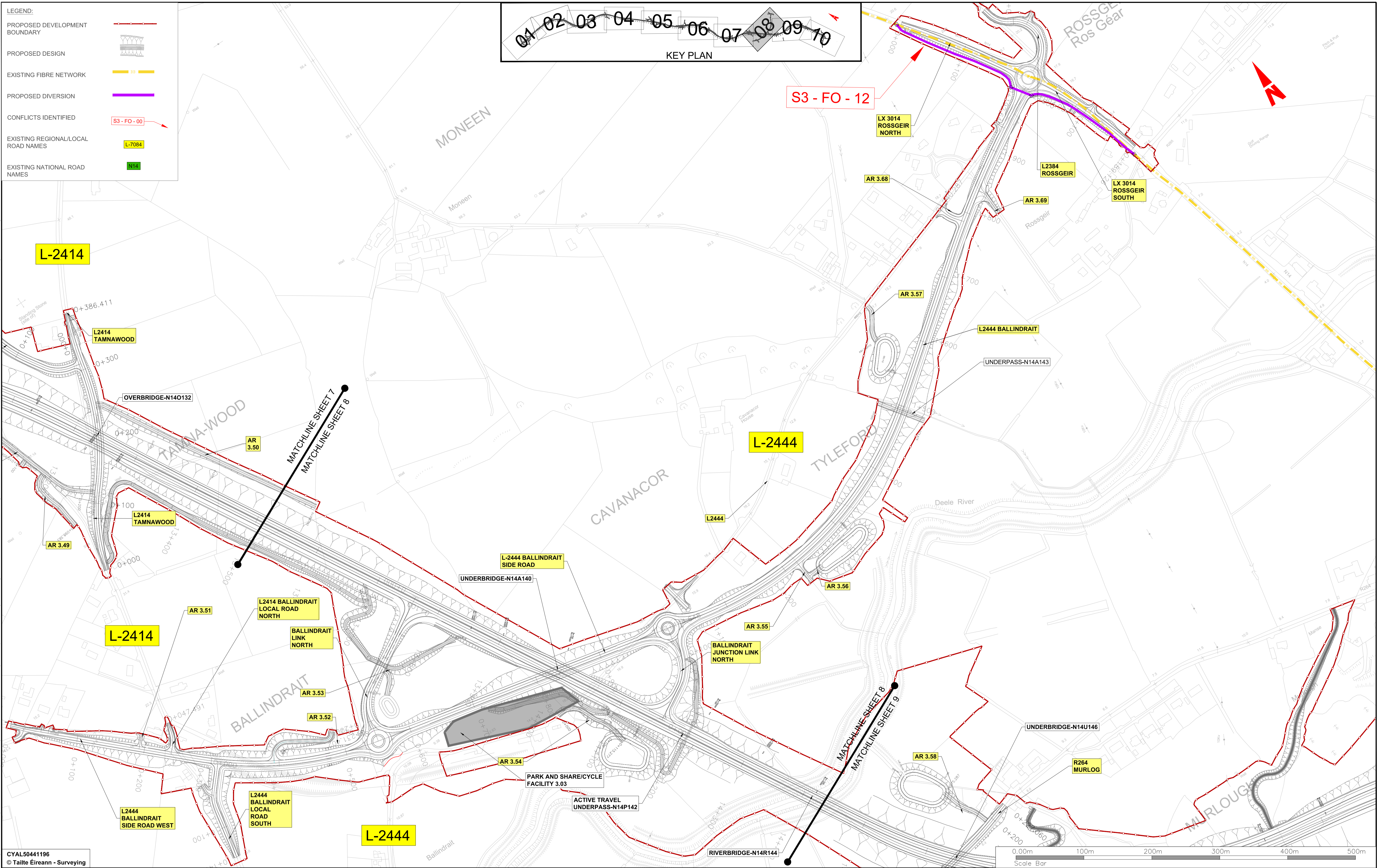
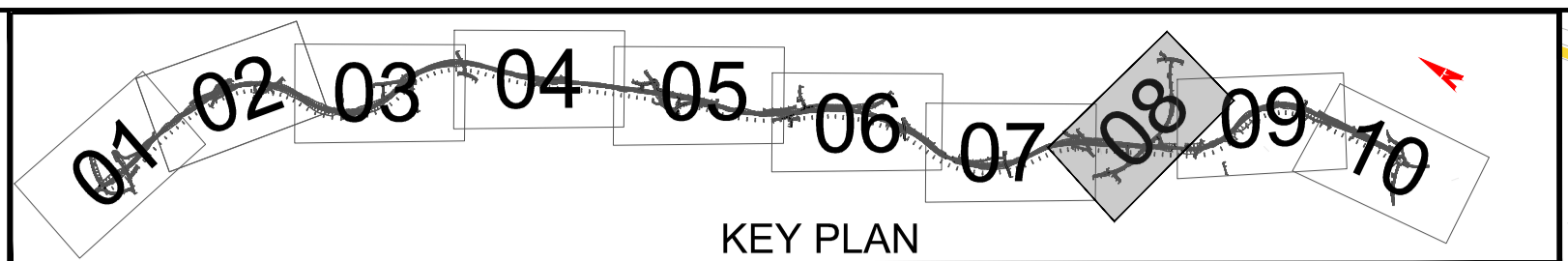

CYAL50441196
© Taitte Éireann - Surveying



Notes
DO NOT SCALE. Use figured dimensions only. All levels are referred to Ordnance Survey Datum, Mean Head.
This drawing is the property of Donegal County Council. It is a confidential document and must not be copied, used, or its contents divulged without prior written consent. This document should not be relied on or used in circumstances other than those for which it was originally prepared. Barry Transportation accepts no responsibility for this document to any other party other than the party by whom it was commissioned.

Rev.	Date	Drawn	Description	Chk'd	Appr.
P01	12.11.25	MG	ISSUE FOR PLANNING	JMM	ED

Project Title: TEN-T PRIORITY ROUTE IMPROVEMENT PROJECT DONEGAL Section 3 - N14 Manor Cunninghamham to Lifford/Strabane/A5 Link

Drawing Title: Proposed Diversions Fibre Project Kelvin

Status: A3

Designed: JMM Date: NOV 2025 EIA Drawing Identifier: Rev: P01

Drawn: MG Scale @ A1: 2500 EIA Drawing 16.19

Approved: ED @ A3: 1:5000 File Identifier: TT_Y16112-BT-1A-HUT-S3-DR-CU-27042

Checked: JMM Sheet: 8 OF 10

\\egis.racine.local\bu_mens\BIB\0 - Projects\Donegal\Projects\Halcrow\Bary\16 Projects\Y16112 - TEN-T Priority Route Improvement Project Donegal\Civil\DWG\Pre\Design\Civil\CAD\WIP\Pre\Design\Civil\DWG\ITT_Y16112-BT-1A-HUT-S3-DR-CU-27042_Proposed_Diversions_Fibre_Project_Kelvin.dwg

V:\gis\racine\localbu_mens\UBS\0 - Projects\Dublin\Projects\Halcrow\Barr\Y16 Projects\Y16112 - TEN-T Priority Route Improvement Project Donegal\Civil\CAD\WIP\Prelim Design\CIV\DWG\ITT_Y16112-BT-1A-HUT-S3-DR-CU-27042_Proposed_Diversions_Fibre_Project_Kelvin.dwg

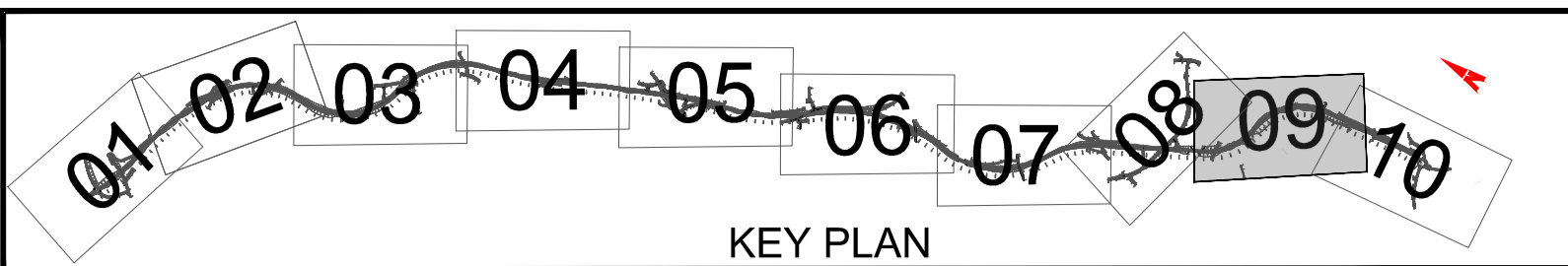
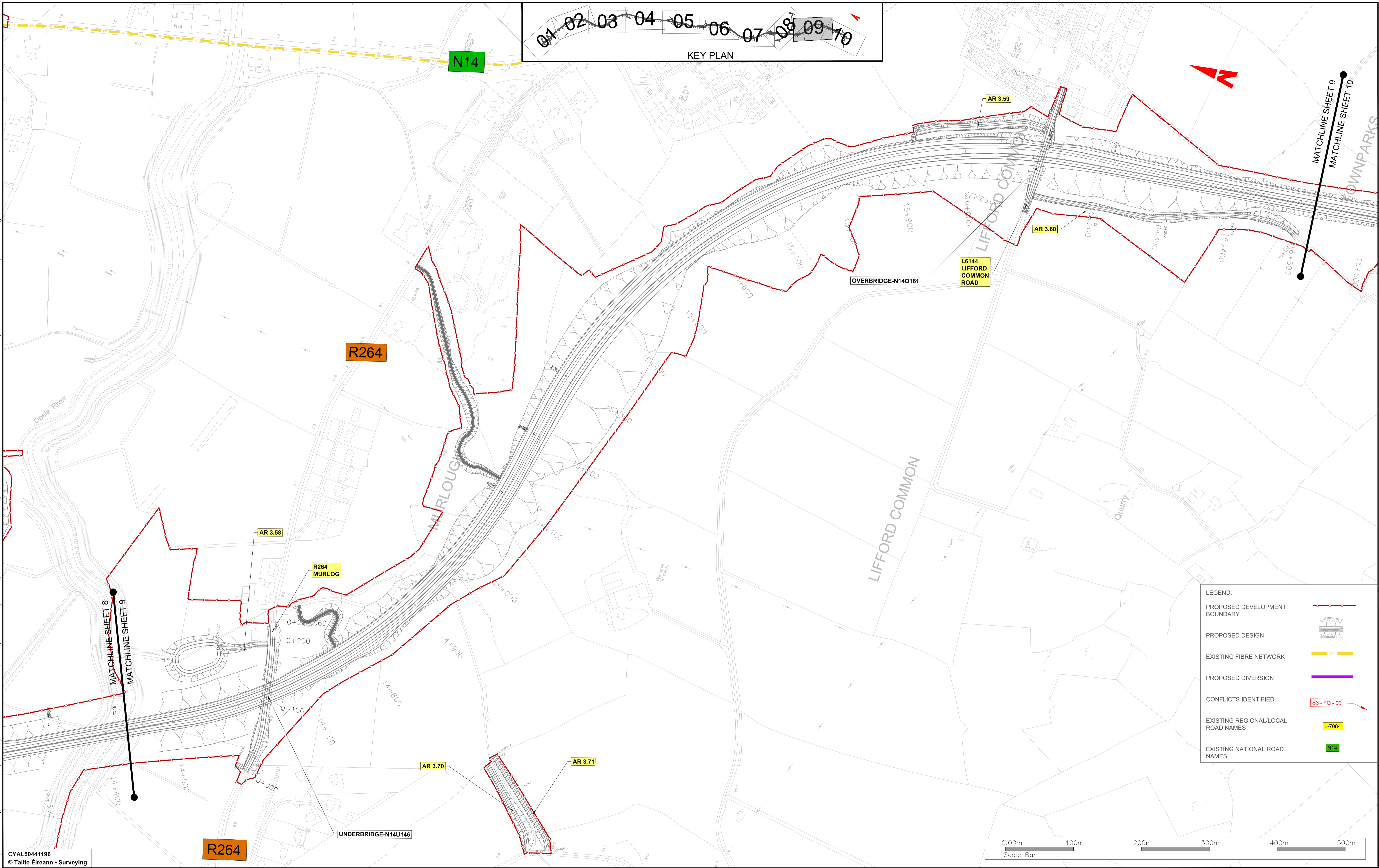

LEGEND:

PROPOSED DEVELOPMENT BOUNDARY	
PROPOSED DESIGN	
EXISTING FIBRE NETWORK	
PROPOSED DIVERSION	
CONFLICTS IDENTIFIED	
EXISTING REGIONAL/LOCAL ROAD NAMES	
EXISTING NATIONAL ROAD NAMES	



CYAL50441196
© Taite Éireann - Surveying



Notes
DO NOT SCALE. Use figured dimensions only. All levels are referred to Ordnance Survey Datum, Mean Head.
This drawing is the property of Donegal County Council. It is a confidential document and must not be copied, used, or its contents divulged without prior written consent. This document should not be relied on or used in circumstances other than those for which it was originally prepared. Barry Transportation accepts no responsibility for this document to any other party other than the party by whom it was commissioned.

Rev.	Date	Drawn	Description	Chk'd	Appr.
P01	12.11.25	MG	ISSUE FOR PLANNING	JMM	ED

Project Title: TEN-T PRIORITY ROUTE IMPROVEMENT PROJECT DONEGAL Section 3 - N14 Manor Cunninghamham to Lifford/Strabane/A5 Link		Status: A3	
Drawing Title: Proposed Diversions Fibre Project Kelvin		Rev: P01	
Designed: JMM	Date: NOV 2025	EIA Drawing Identifier:	
Drawn: MG	Scale @ A1: 1:2500	EIA Drawing 16.19	
Approved: ED	@ A3: 1:5000	File Identifier:	
Checked: JMM	Sheet: 9 OF 10	TT_Y16112-BT-1A-HUT-S3-DR-CU-27042	

